



OAKLAND CITY UNIVERSITY CAMPUS MAP

UNIVERSITY ATHLETIC FIELDS

- 1 Aigner Field, Soccer
- 2 Outdoor Basketball Courts
- 3 Pinnick Baseball Field
- 4 Tennis Courts

UNIVERSITY HOUSING

- 5 Brokaw Hall, Women
- 6 Carriage House Apartments
- 7 Cox Hall, Women
- 8 Dearing Hall, Men
- 9 Jordan Hall, Men

UNIVERSITY BUILDINGS

- 10 Barger-Richardson Resource Center (Library)
- 11 Bower-Suhrheinrich Student Life Center
- 12 Chapman Seminary
- 13 Cockrum Hall
- 14 Cornwell-Reed Center, Music & Arts
- 15 Dearing Hall, Faculty and Staff Offices
- 16 Johnson Center, Gymnasium
- 17 Kennedy Center, Education and Science Building

- 18 Murray Administration Center
- 19 Criminal Justice Crime Scene House
- 20 Tichenor Athletic Fieldhouse
- 21 Deaconess Health Clinic
- 22 Provance Memorial Chapel

PARKING

- Campus Parking
- Residence Hall Parking Only
- Staff Parking

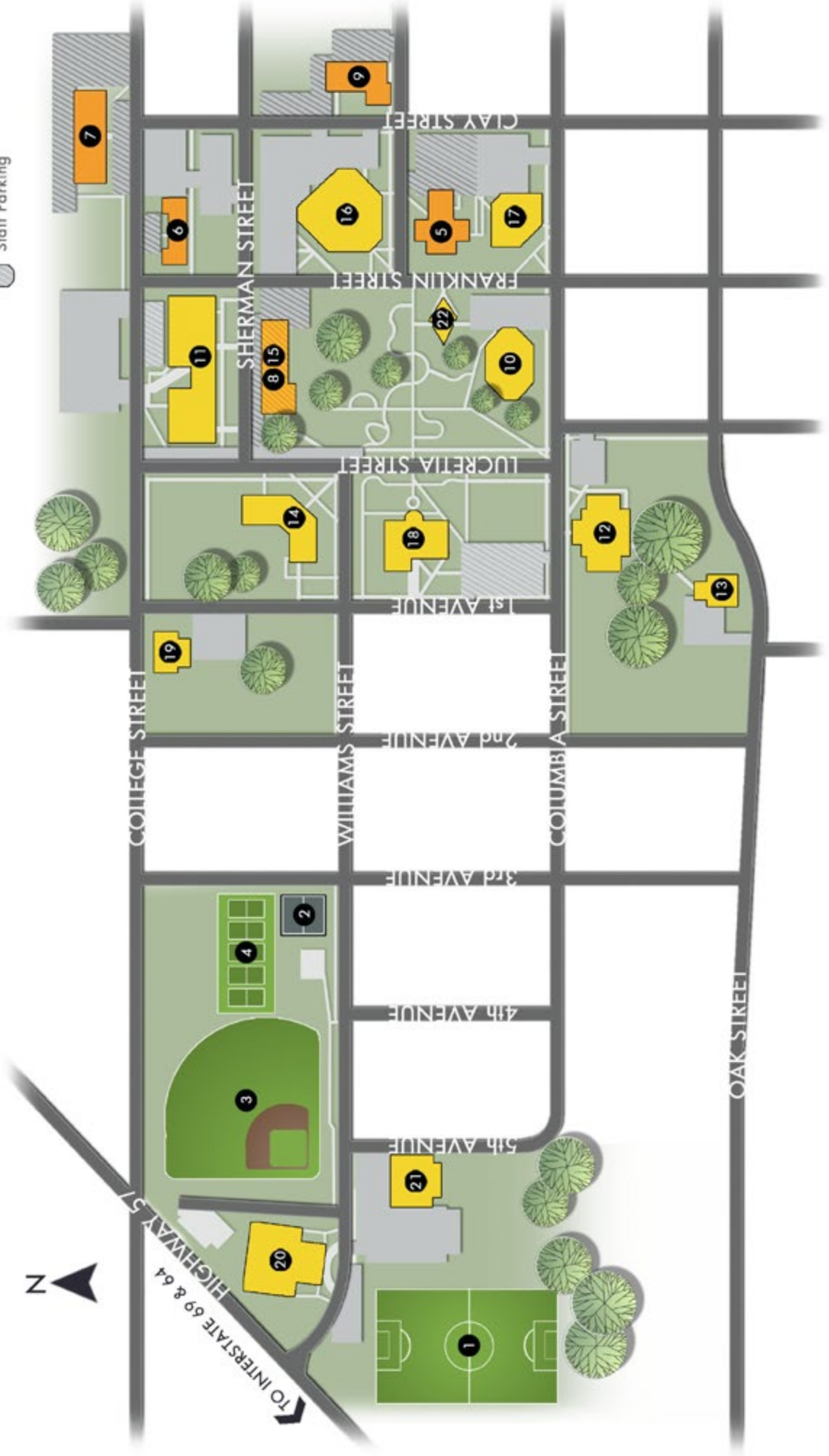

DRIVING DIRECTIONS

Oakland City University's Main Campus is located in Southwestern Indiana. It is within driving distance of several metropolitan areas including: Evansville (30 minutes), St. Louis (182 miles), Louisville (100 miles), Nashville (162 miles), Cape Girardeau (177 miles), Cincinnati (213 miles), and Jonesboro (269 miles). The campus is ideally situated in the rural community of Oakland City, with a population of 3,000, just 14 miles North of 164 on Indiana Highway 57.

From the East

Take I-64 west towards St. Louis. Exit at 29B, I-69 north and follow for approximately 15 miles. Take exit #33 (Princeton/Oakland City/Huntingburg) and turn right onto Hwy 64 east. Go approximately 2 miles to the junction of Hwy 57 & Hwy 64. Turn left (north) onto Hwy 57 for approximately 1 mile, turn right (east) at the Oakland City University entrance onto Williams Street. The Murray Administration Building is located 4 blocks up Williams Street on the right.

From the West

Take I-64 East towards Louisville. Exit at 29B, I-69 north and follow for approximately 15 miles. Take exit #33 (Princeton/Oakland City/Huntingburg) and turn right onto Hwy 64 east. Go approximately 2 miles to the junction of Hwy 57 & Hwy 64. Turn left (north) onto Hwy 57 for approximately 1 mile, turn right (east) at the Oakland City University entrance onto Williams Street. The Murray Administration Building is located 4 blocks up Williams Street on the right.

From the North

Take US-41 South. Take IN-64 east towards Princeton. Continue through Princeton and into Oakland City (15 miles). Turn left onto IN-57 North. Drive approximately one mile and turn right onto Williams Street. The Murray Administration Building is located 4 blocks up Williams Street on the right.

From the South

Take US-41 (Pennyrile Parkway) north. Take I-164 east and continue for approximately 15 miles, it will become I-69, continue north and take exit #33 (Princeton/Oakland City/Huntingburg). Turn right (east) on Hwy 64. Go approximately 2 miles to the junction of Hwy 57 & 64. Turn left (north) onto Hwy 57 for approximately 1 mile, turn right (east) at the Oakland City University entrance onto Williams Street. The Murray Administration building is located 4 blocks up Williams Street on the right.

From Indianapolis

Take I-70 west. Continue on I-70 west. Take exit 7 for US-41 S towards Evansville. Continue to follow US-41 S. Exit onto IN-64 E towards Princeton. Continue to follow IN-64 East. Turn left (north) onto Hwy 57 for approximately 1 mile, turn right (east) at the Oakland City University entrance onto Williams Street. The Murray Administration building is located 4 blocks up Williams Street on the right.

EVANSVILLE HOTELS - Ask for the Oakland City University discount rate!



BOOK NOW! Call 812-471-3414



La Quinta Inn & Suites
8015 E. Division St., Evansville, IN. 47715



BOOK NOW! Call 812-477-2677



Baymont Inn & Suites
8005 E. Division St., Evansville, IN. 47715



BOOK NOW! Call 812-867-2200



Holiday Inn Express & Suites, North
324 Rusher Creek, Evansville, IN. 47725



BOOK NOW! Call 812-473-2500



Country Inn & Suites
301 Circle Front Dr., Evansville, IN. 47715